

# Laser Barcode Scanner User Manual



Factory Default



Version V5.8

## Introduction

This is a easily use manual for laser barcode scanner , if you need the more details about how to use , please download from our official website or get the manual from distributors.

## Installation

### ☑ keyboard wedge cable install

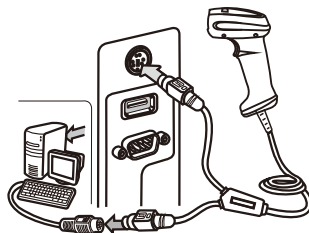

keyboard wedge cable install

### ☑ RS-232 Cable install

1. Turn off the power supply
2. Put the DB9 connector connection with the device interface.
3. If the device (The 9<sup>th</sup> pin of serial) can not working , please connect the 5V power supply with cable.
4. Turn on the power .if the buzzer and LED light release the signal, so the the device is working normal.

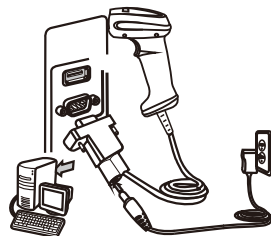

RS-232 Cable install

### ☑ USB Cable install (put the cable insert the USB serial directly, The Computer will detection and identification automatically)

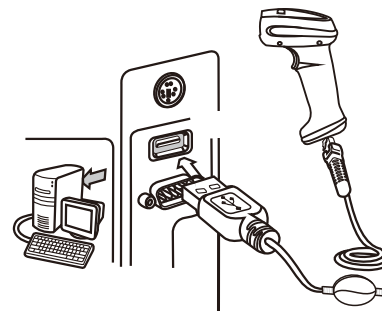

### ☑ Accessories: Bracket install

1. Use the bracket connector connect to the main body of bracket.
2. Main body of bracket.
3. Philip's screw, Dimensions: M6\*10MM
4. Base Support
5. Direct wedged in the base of bracket when the head of bracket and main body connection well.

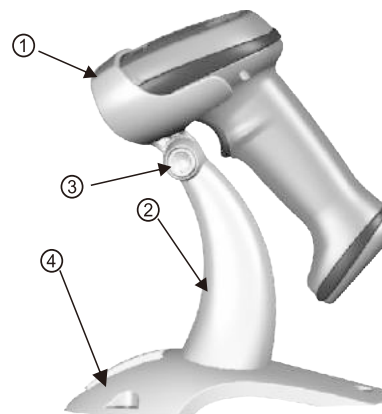

## Interface Choose



USB-HID Model\*



Ps2-Keyboard Model



USB-COM Model



COM-RS232 Model

## Scanning Type



Automatic successive scanning mode



Automatic flashing mode

## Buzzer



Sound OFF



Sound ON

## Barcode Display Tybe



Display barcode type after barcode



UN-Display type after barcode

## Keyboard Model

### ☑ Language Choice



USA



German



France

### ☑ Keyboard Caps Lock control



Resume



Capitalize



Lower case

## COM Model

### ☑ Baud Rate



4800



9600



19200



38400



57600



115200

### ☑ Prefix&Suffix Setting



AddPrefix



AddSuffix



Hide Before  
Character



Hide After Character

## Special Code ON



CODE11



CODE 39



FULL ASCII



CODE 93



CODE 128



CODE 128ISBT



CODEBAR



Enable Interleaved  
2 of 5



Industrial 2 of 5



Matrix 2 of 5



CHINA POST CODE



MSI CODE



UPC-A



UPC-E



EAN-13



EAN-8

### ☑ Suffix & Skip Setting



CR



LF



CR&LF



Tab



Space



None

### Wireless Setting



RF Model



Delete Add



Setting DeviceADD



01



02



03



04



Pairs Add



Inventory Mode



Upload New Data



Upload All Data



Upload Statistic Data



Clear